

- Compact design
- BNC Female to female
- Joiner
- Quality long life
- Nickel plated
- Gold plated conductor/pin

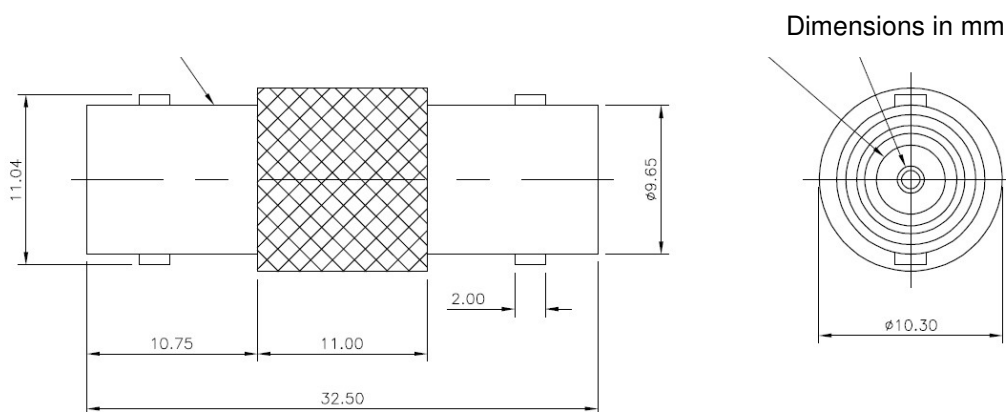

The BNC joiner is a compact and high quality joiner widely used in data acquisition and sensor measurement applications.

The body is fully nickel plated and the critical connections are gold plated.



Variable	Value
<b>Electrical</b>	
Impedance	50Ω
Frequency Range	0 ~ 4GHz
Working Voltage (max.)	500V max
Withstand Voltage	1500Vrms
Insulation Resistance	≥5000MΩ
VSWR (Voltage Standing Wave Ratio)	≤1.2
<b>Physical</b>	
Body	Nickel Plated Brass
Centre Conductor	Gold plated brass
Insulator	PTFE
Temperature Range	-45°C to +120°C
Durability	>500 connections

Due to continued product development Kemo Limited reserve the right to change specification without notice.